

# Walk & Whoa Obstacle Pattern

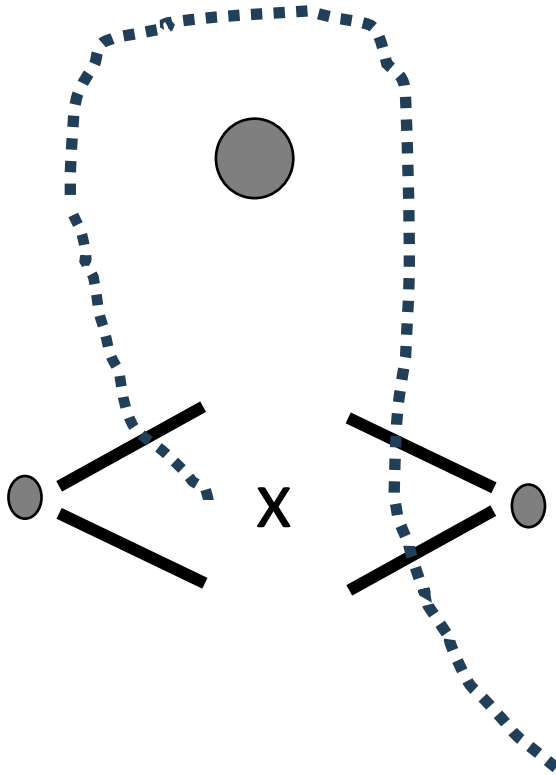

- 1 Walk over fan of 2 ground rails
  - 2 Walk around marker
  - 3 Walk over 3<sup>rd</sup> ground rail
- Halt in center of pattern

# Walk / Trot Obstacle Pattern

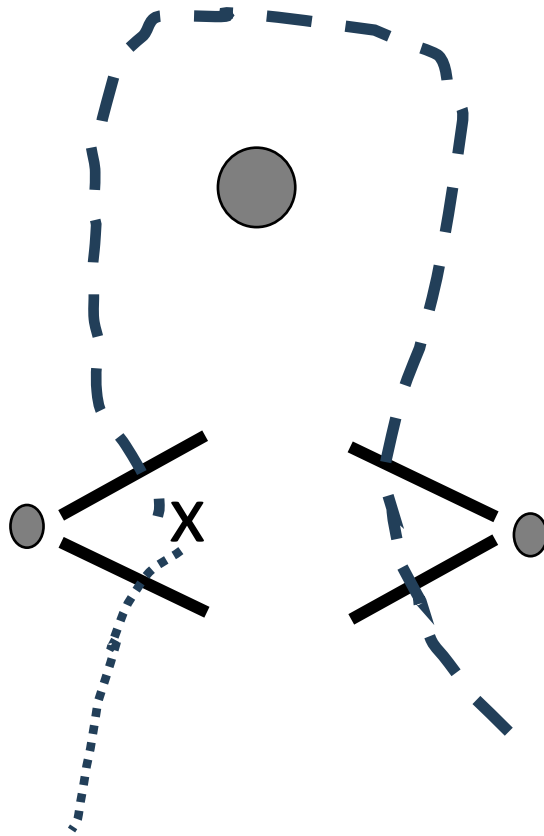

- 1 Trot over fan of 2 ground rails
- 2 Trot around marker
- 3 Trot over 3<sup>rd</sup> ground rail
- 4 Halt between 3<sup>rd</sup> and 4<sup>th</sup> ground rail
- 5 Exit at a walk over 4<sup>th</sup> ground rail

# Walk / Trot / Canter/Lope Obstacle Pattern

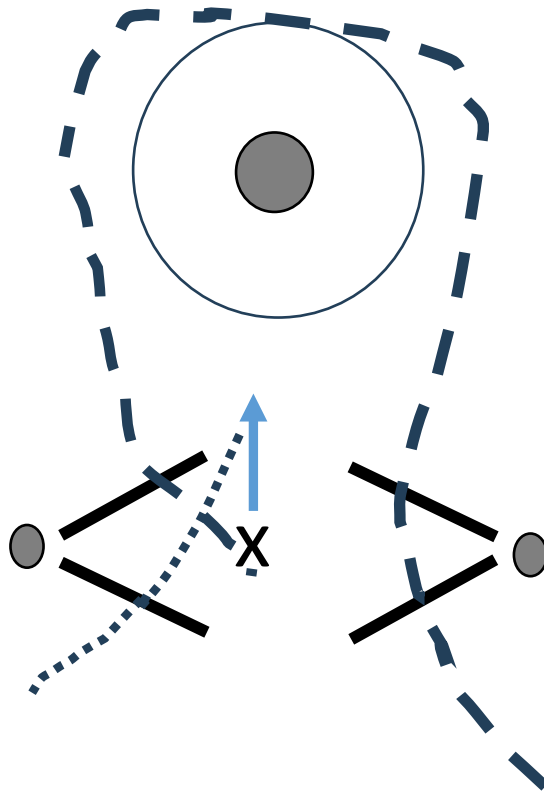

- 1 Trot over fan of 2 ground rails
- 2 Trot around marker to the top of pattern
- 3 Circle at a Canter/Lope left lead around marker
- 4 Trot over 3<sup>rd</sup> ground rail
- 5 Halt between 3<sup>rd</sup> and 4<sup>th</sup> ground rail
- 6 Back 4 steps
- 7 Exit at a walk over 4<sup>th</sup> ground rail

# Showmanship

Therapeutic, Leadline, 10 & under, Jr Youth 13 & under,  
Miniature Horse Youth & Mini Therapeutic

Open until noon

- Start at marker A
- Walk from marker A to B, Stop
- Back 5 steps
- Walk to Judge
- Set up for inspection
- When dismissed, exit rig at the trot

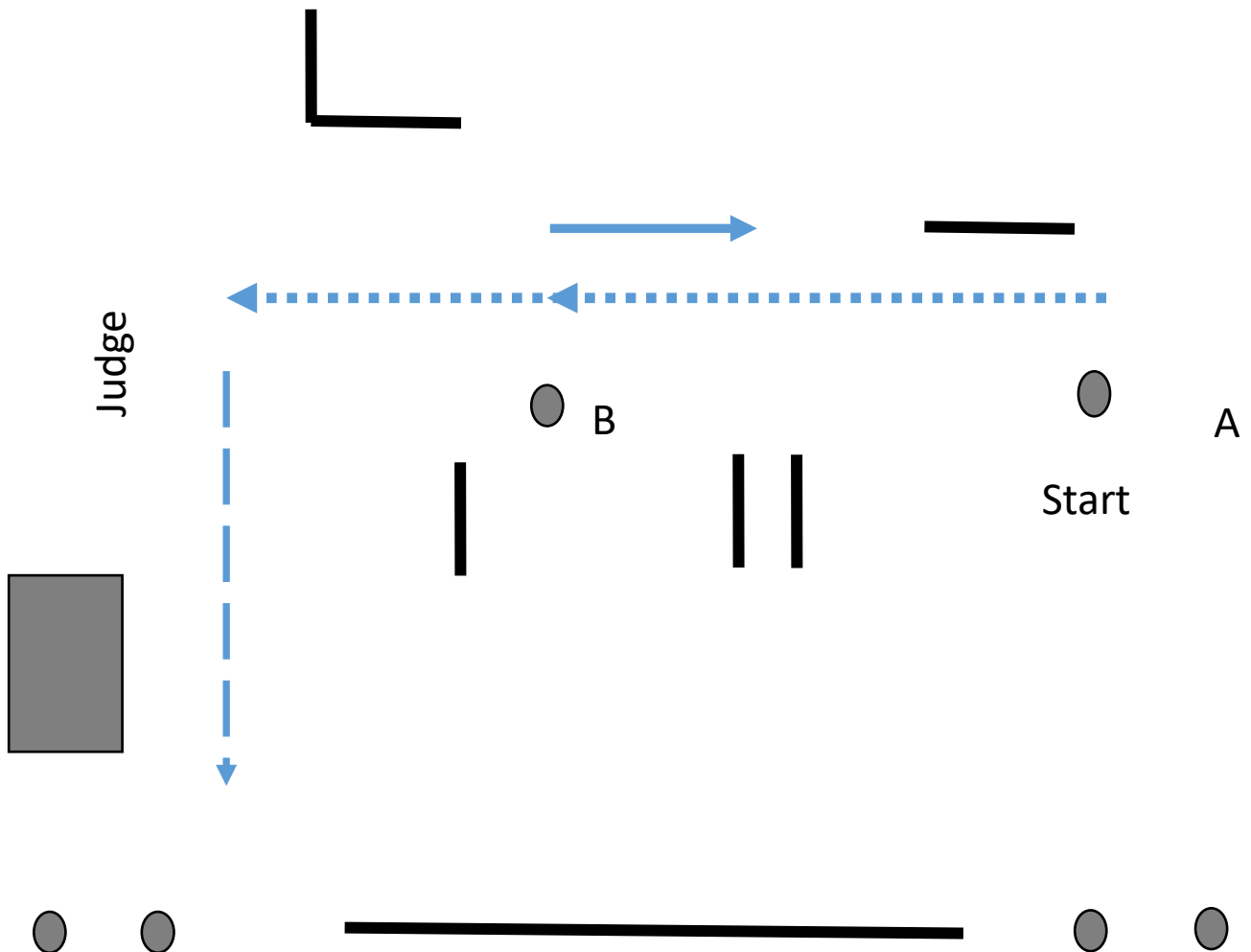

# Showmanship

Sr Youth 14 - 17, Adult & Miniature Horse Adult

Open until noon

Start at marker A

Trot from marker A to B, Stop

Perform a 360-degree push turn

Walk to Judge

Set up for inspection

When dismissed, Perform a 270-degree turn, exit rig at the trot

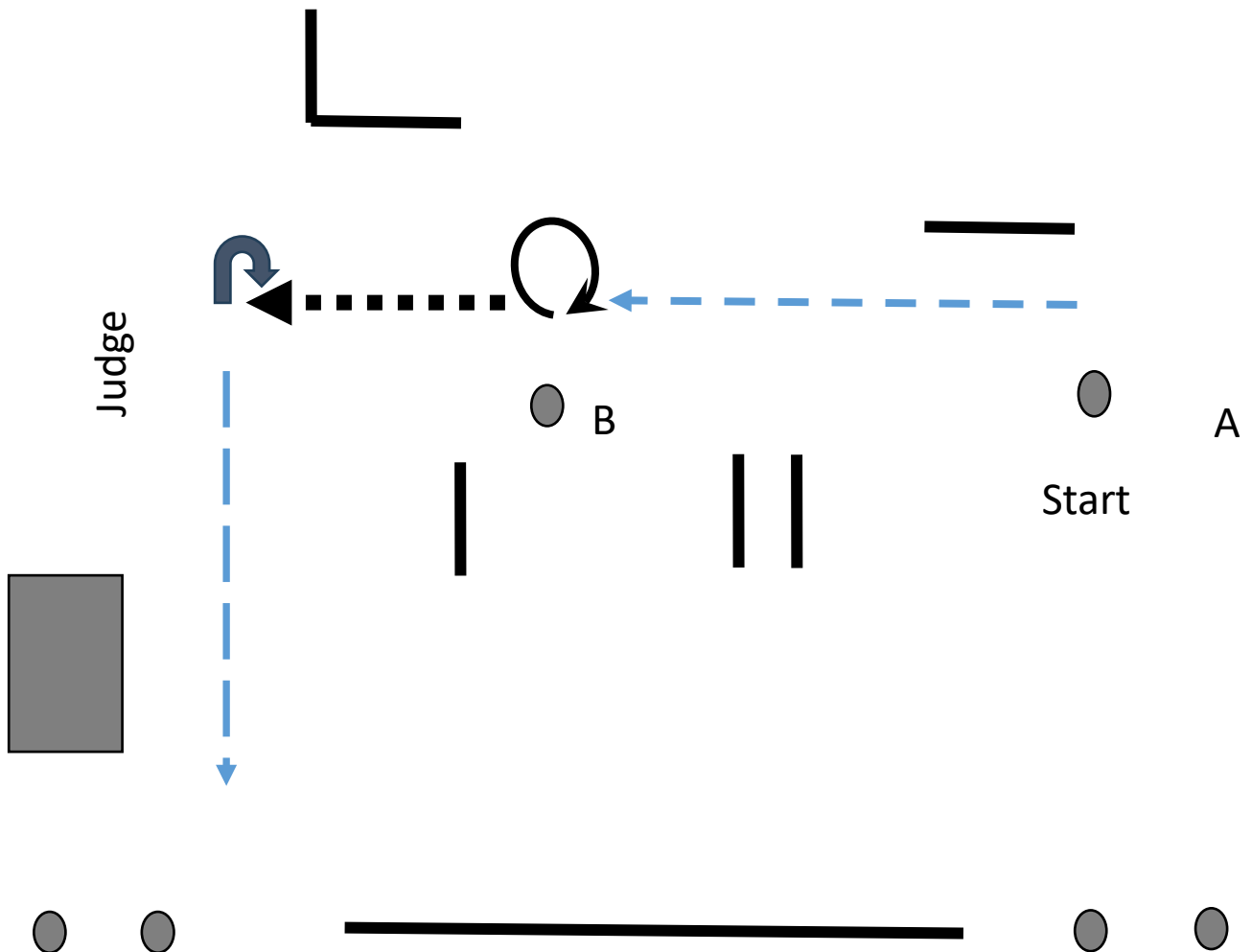

# In Hand Ground Poles

Therapeutic, Leadline, 10 & under, Jr Youth 13 & under,  
& Mini Therapeutic  
Open until noon

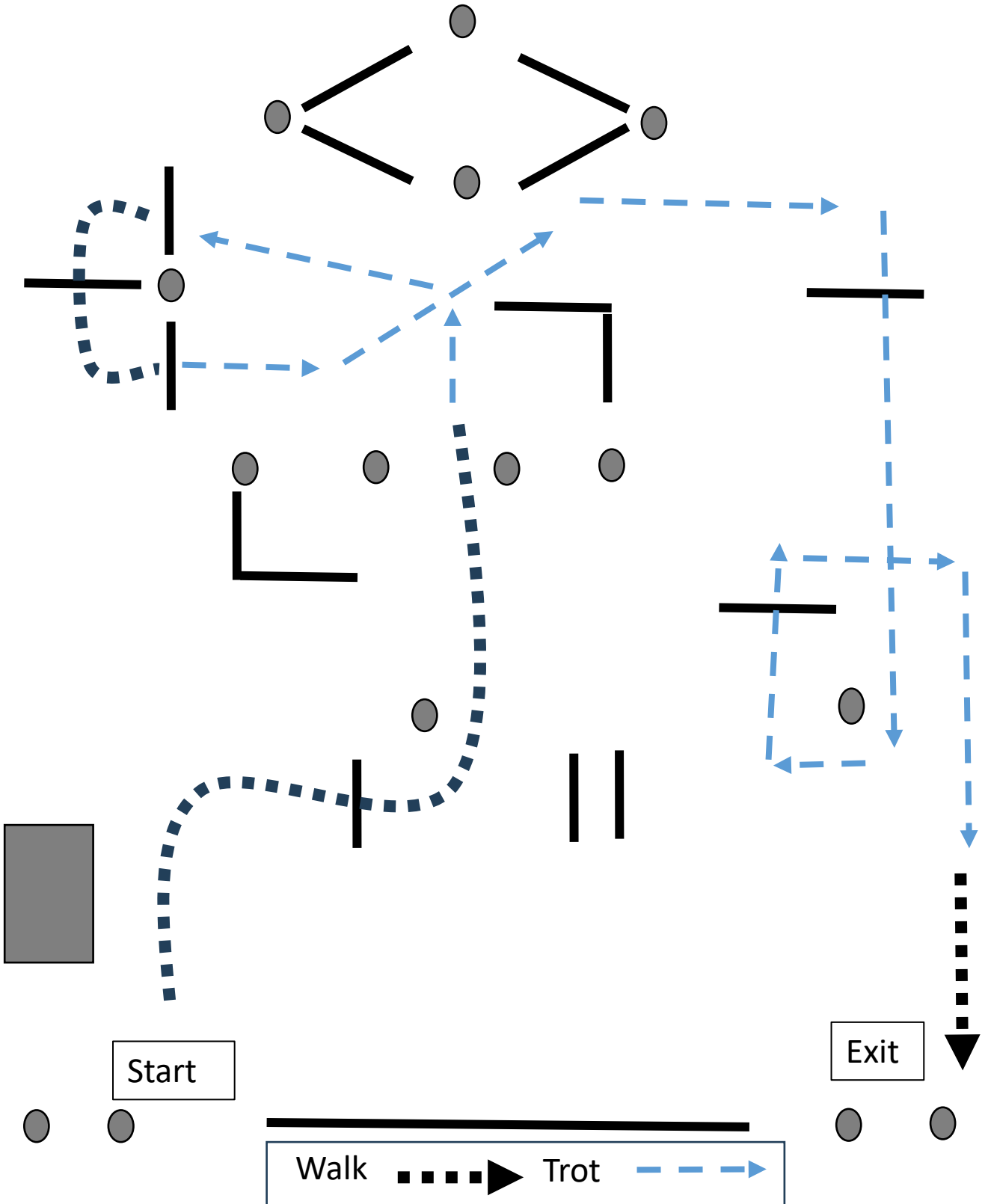









# Miniature Horse Jumping

## Course A

Open until noon

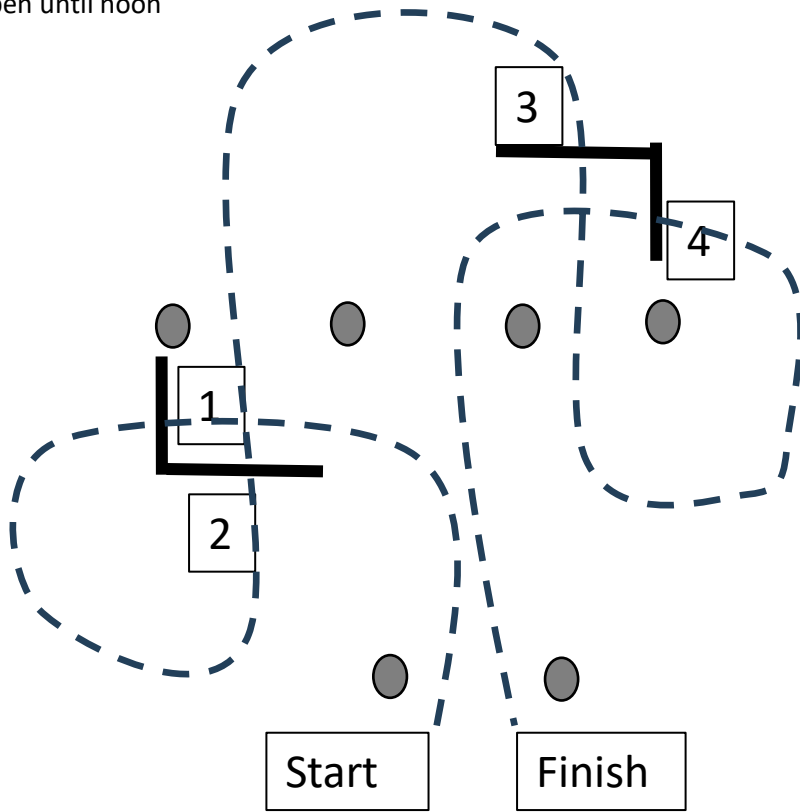

## Course B

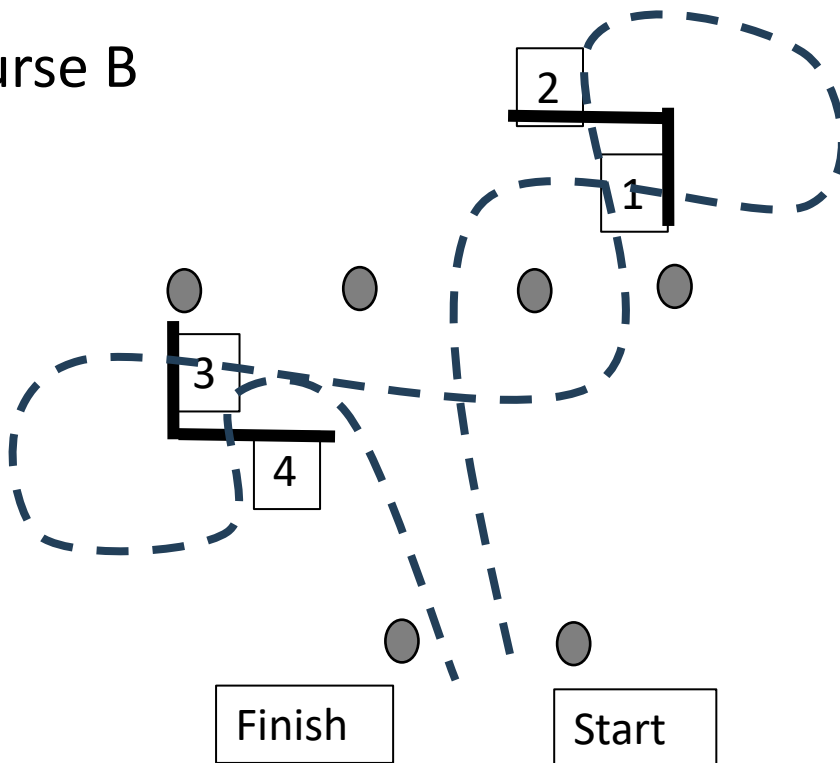

# WT Lead Line, 10 & Under, 13 & Under and Therapeutic Trail

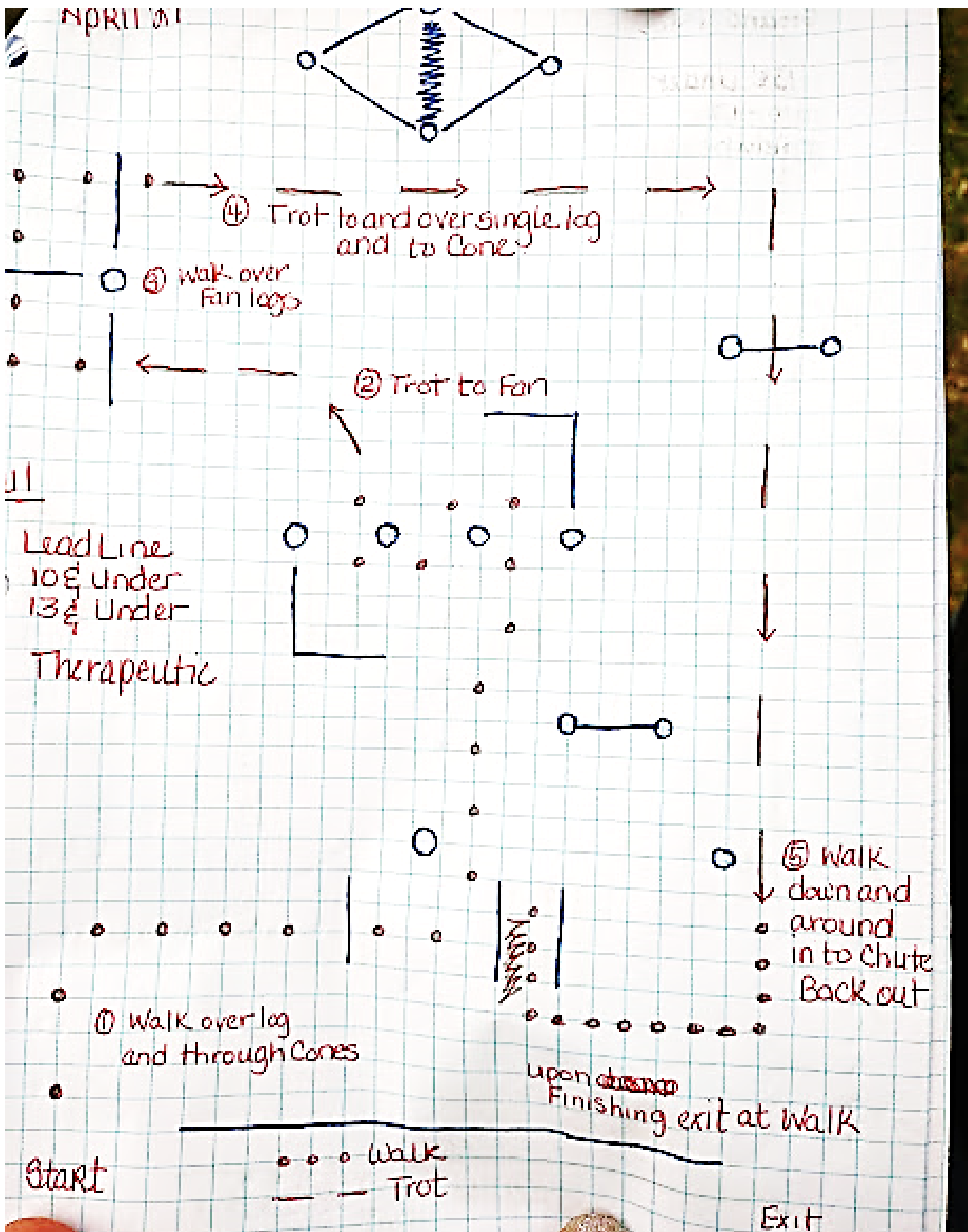

# 14-17 and Adult Trail

WRC  
April 27

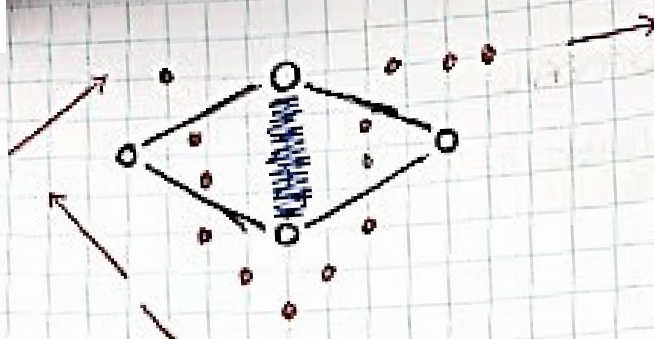
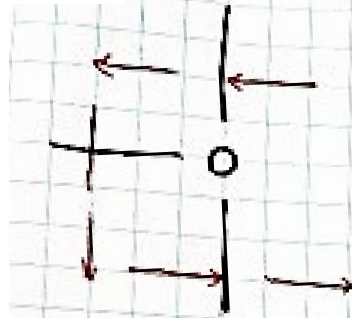

Trail

● 14-17  
● Adult

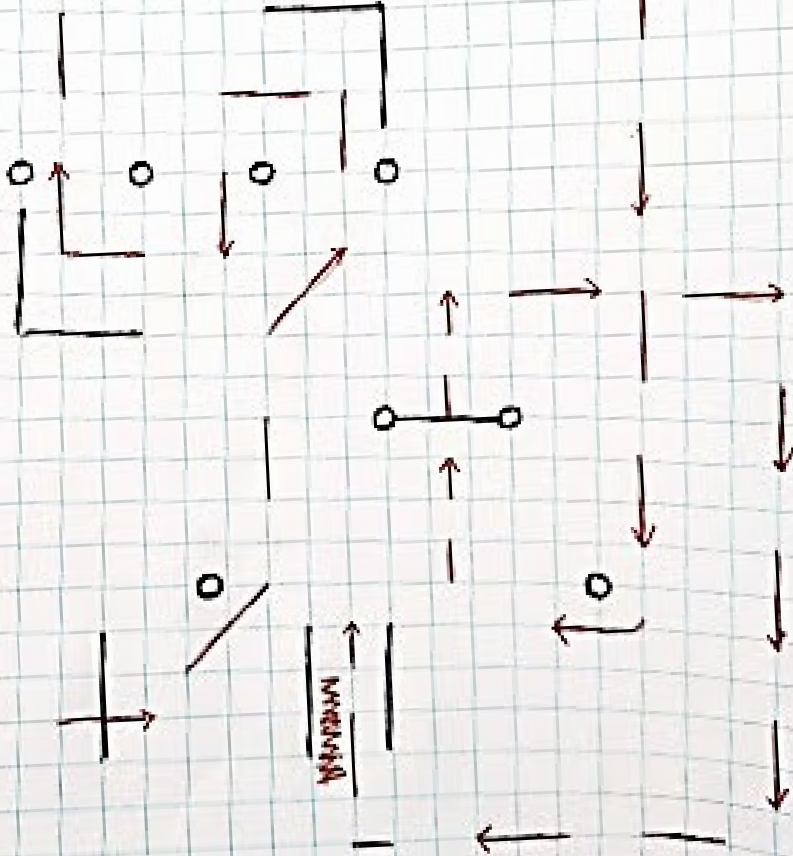

J

Upon Finishing exit  
at the walk

Start

● ● ● Walk  
- - - Trot

WALK BACK

Exit

# Mini Youth & Adult In Hand Trail

